



RENTAL SPACES, AVAILABILITY, AND FEES

ROOM AVAILABILITY

The Magnes is open to the public Tuesday–Friday, 11 AM–4 PM during the UC Berkeley academic year, and is closed for summer and winter breaks. Please check our website for exact dates. The Auditorium and Conference Room may be reserved during open hours. The Lobby may not be reserved while The Magnes is open to the public. The Magnes is wheelchair accessible, with accessible restrooms.

Please read and review the “Facilities Rules of Use” for a complete list of facility rules and regulations.

RENTAL SPACES

The Auditorium: The Magnes’ main event space is a sophisticated setting for special events, lectures, or banquets. The 2,500 square-foot room has 20-foot ceilings (with acoustical baffling) and polished concrete floors. Skylights flood the room with sunlight during the day, and a state-of-the-art lighting system allows for customized light levels at night. The accessible 12-foot by 14.5-foot concrete stage provides ample room for musicians or speakers and is equipped with a sound system, projector and screen, and four stage lights. Up to 200 plastic chairs, two eight-foot, and 10 six-foot rectangular tables may be available for use in the auditorium with prior arrangements.

When The Magnes is closed to the public, Auditorium rentals include use of the Lobby.

Availability	Food/Drink	Theater/Lecture	Banquet	Standing Reception
Open and Closed Hours	Allowed	200	150	350

The Conference Room: Located behind glass doors, the Conference Room is furnished with a large central table and comfortable chairs. Ideal for meetings and small workshops, this room seats 10. Portable A/V equipment can be used in this room. On its own, this room may be rented during public hours only.

Availability	Food/Drink	Meeting
Open Hours Only	Allowed	10

The Lobby: The large Lobby can be used for standing receptions or guest check-in, and is included in the rental of the Auditorium when The Magnes is closed to the public.

Availability	Food/Drink	Standing Reception
Closed Hours Only	Allowed (some restrictions)	55

ROOM RATES

Rental periods include setup and break down/cleanup time. If half-day rentals go over four hours, they will be charged the full day rate. Rental rates are for UC Berkeley and Non-profit groups only.

Space	Half day (up to 4 hrs)	Full Day (4-8 hrs)	Each Additional Hour or portion thereof
Auditorium (Museum Open Hours)	\$800	N/A	\$250, 5-hour maximum
Auditorium + Lobby (Museum Closed Hours)	\$1200	\$1500	\$350
Conference Room (Museum Open Hours)	\$275	N/A	\$150, 5-hour maximum
Exclusive Rental (Entire Building)	\$1800	\$2500	\$350
Cleaning Fee	\$210	\$420	\$52.75

THE MAGNES FLOORPLAN

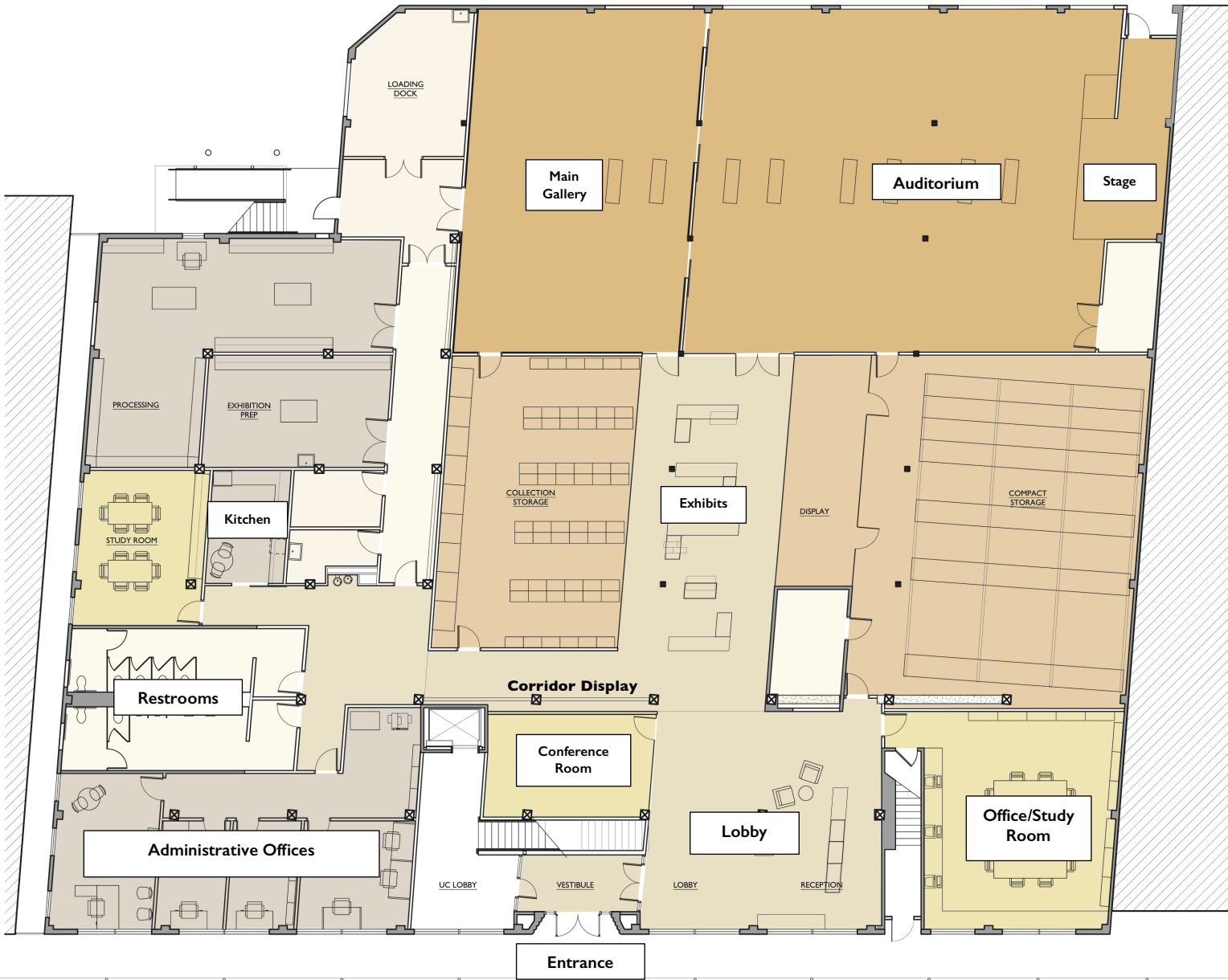

2121 Allston Way